



# THE LAST & THE LATEST

The **last** remaining luxury waterfront condominium with resort-style amenities in Miami's exclusive Bay Harbor Islands, and the **latest** project from visionary Continuum South Beach developer, Ian Bruce Eichner.

Complete with private boat slips, this limited-edition bayfront condominium offers two-to-four- bedroom residences spanning between 1,400 to 2,100 square feet.

# BUILDING & RESIDENCES

## BUILDING FEATURES

- Exclusive collection of fifty-seven luxurious two-to-four- bedroom residences spanning between 1,400 to 2,100 square feet
- Naturally private, verdantly lush landscaped arrival with porte-cochère entrance
- Expansive lobby with exquisite finishings and double height glass windows overlooking the water
- Five-minute walk to the Atlantic Ocean's sandy beaches and Bal Harbour Shops
- Pet-friendly building conveniently located two blocks from the dog park
- Covered bicycle storage racks with direct outdoor pathway access
- Four high-speed elevators with two dedicated elevator lobbies
- Electronic fob-controlled access to elevators, common areas and amenities
- Dedicated Mailroom with separate room for packages
- Electric vehicle charging stations for both residents and guests
- Emergency generator to power select residential comforts
- Pre-wired for internet & cable TV; Wi-Fi throughout all common areas

## PRIMARY BATHROOMS

- Custom European cabinetry
- Vanity with double-sinks
- Premium fixtures and fittings
- Natural marble stone flooring
- Glass-enclosed shower featuring dual rainfall shower heads

## THE RESIDENCES

- 9' ceilings in Residences
- 10' ceilings in Upper Penthouses
- Private terraces with unobstructed views of Biscayne Bay, the Atlantic Ocean, Bal Harbour, Miami Beach and downtown Miami
- Floor-to-ceiling, impact resistant sliding glass doors and windows
- All residences delivered fully-finished
- Imported European wide-plank wood flooring and marble stone in bathrooms
- Well-appointed fixtures & finishes curated by New York-based Durukan Design
- Den/Home Office with a full bath for lounging and convenient "work from home" space
- In-residence laundry room with energy-efficient, full-size, Miele® washer and dryer set
- Generously sized double-closet space, including walk-in closets in Primary Bedrooms
- Additional full-bathroom or powder room outfitted to accommodate guests
- Additional private storage spaces included with each residence

## KITCHENS

- Custom European cabinetry and kitchen pantry
- Miele® appliance package including: electric cooktop, wall oven, dishwasher, refrigerator and microwave
- Quartz stone countertops
- Top-of-the-line Hansgrohe® fittings
- Miele® wine coolers exclusively in Penthouses

# AMENITIES & SERVICES

## SERVICES

- 24/7 Front Desk Reception
- 24/7 Full-service Valet for residents and guests
- Full-time Property Manager with on-site office
- Tesla® House Car located within the building offering residents on-demand transportation

## AMENITIES

- 20,000 square feet of resort-style amenities; including over 8,500 square feet of lush tropical landscaping and open green spaces throughout
- 10,000 square foot Rooftop Amenity Deck with dedicated Kids' Area and Adults' Area
- Relaxing Pool with sun-shelf and immersed, shallow sun-loungers
- Expansive Poolside Sundeck with chaise loungers and shaded daybed nooks
- Tropical rooftop heated Adult Soaking Spa overlooking Biscayne Bay and the Atlantic Ocean
- Lounge areas with overhanging pergolas to provide comfortable shade
- Outdoor rooftop Summer Kitchen and dining area with spectacular bay views
- Rooftop Sunset Lounge with cozy seating, firepit and breathtaking sunset views
- Private seating nooks and hanging swing nests for secluded relaxation
- Private business offices with exquisite furnishings designed for productivity and quiet moments
- Residents' Club Room overlooking the water with lounge seating, a movie theater and private bar for entertaining
- State-of-the-art Fitness Center with the latest cardio and weight training equipment

## WATERFRONT LEISURE

- Private boat slips exclusively for residents
- Dock-side pick-up and drop-off area
- Direct ocean access for boating and water activities via Haulover Inlet
- Water sports launch dock with kayaks, inflatables and paddleboards provided to residents
- Sunrise Terrace with dock-side lounge seating overlooking Biscayne Bay
- Dock-side lawns with waterfront bench seating, daybeds with flowering overhead trellises, and lazy hanging hammocks offering views of Biscayne Bay

## JUST FOR KIDS

- Rooftop Kids' Splash Pad
- Dedicated Kids' Play Lawn
- Kids' rooftop Grill Station for outdoor dining
- Outdoor rooftop Kids' play tents
- Kids' rooftop hanging nest swings
- Study Pod areas ideal for homework or tutoring

## THE TEAM

- Envisioned by **Ian Bruce Eichner**, developer of the iconic Continuum South Beach
- Architecture by the internationally acclaimed **Luis Revuelta**
- Landscapes and Pool Design by the renowned **C. Right Studios**
- Interiors curated by **Durukan Design**
- Built by **Suffolk Construction**
- Sales and Marketing by **PGutman, LLC**
- Creative by **Simply**

# BAY HARBOR ISLANDS & THE SURROUNDING NEIGHBORHOODS

Bay Harbor Islands is a distinctly small and exclusive community that has become one of the most-highly desired luxury residential waterfront areas throughout Miami and Fort Lauderdale. Within just a one-mile radius, Bay Harbor Islands' residents enjoy easy-access to casual cafés, fine dining, neighborhood services, world-class shopping, parks and recreation for every age, as well as top-ranked schools – all just a short walk from La Baia North.

## BAY HARBOR ISLANDS DEDICATED NEIGHBORHOOD SERVICES

- Bay Harbor Islands Police Department
- Bay Harbor Islands Fire Station
- U.S. Parcel Office
- Branch Library
- A+ rated Ruth K. Broad Bay Harbor K-8 Center (one of the highest ranked schools in Miami-Dade County)
- Complimentary Bay Harbor Islands Shuttle Service that runs Monday through Friday, from 9 a.m. to 5 p.m. with connections to Bal Harbour, Aventura, Sunny Isles Beach, Haulover Beach, North Miami, Surfside and the North Beach & Miami Beach Trolley systems

## BAY HARBOR ISLANDS PARKS

- Bay Harbor Islands Tot Lot
- Town of Bay Harbor Islands Park
- 92nd Street Park
- 95th Street Tennis Courts & Park
- Officer Scott Winters Park

## BAY HARBOR ISLANDS DINING

- Bistro Bakery
- Coffee Break
- Emilio's Trattoria
- Foozoo Artizan Pizza
- Meat Bar Restaurant
- Mestizo Gastro Fusion
- O'Lima Peruvian Gastrobar
- The Palm (Classic American Steakhouse)

## BAL HARBOUR SHOPS (0.8 MILE)

Bal Harbour Shops is a 466,000 square foot open-air dining and luxury shopping experience. Notable luxury retailers and fine-dining restaurants include:

### FINE-DINING RESTAURANTS

- Bianco Gelato
- Café en 3 at Neiman Marcus
- Carpaccio
- Hillstone at Bal Harbour
- Le Zoo
- Makoto

### LUXURY RETAILERS

- Audemars Piguet
- Bottega Veneta
- Chopard
- Christofle
- Fendi
- Harry Winston
- Gucci
- Lalique
- Louis Vuitton
- Neiman Marcus
- Prada
- Saks Fifth Avenue
- Saint Laurent
- Salvatore Ferragamo
- Tom Ford
- Versace

## NEAREST BEACH ACCESS (0.6 MILE)

Directly access the sand and Atlantic Ocean with a short five-minute walk from La Baia North.

# PRIVACY WITH PROXIMITY

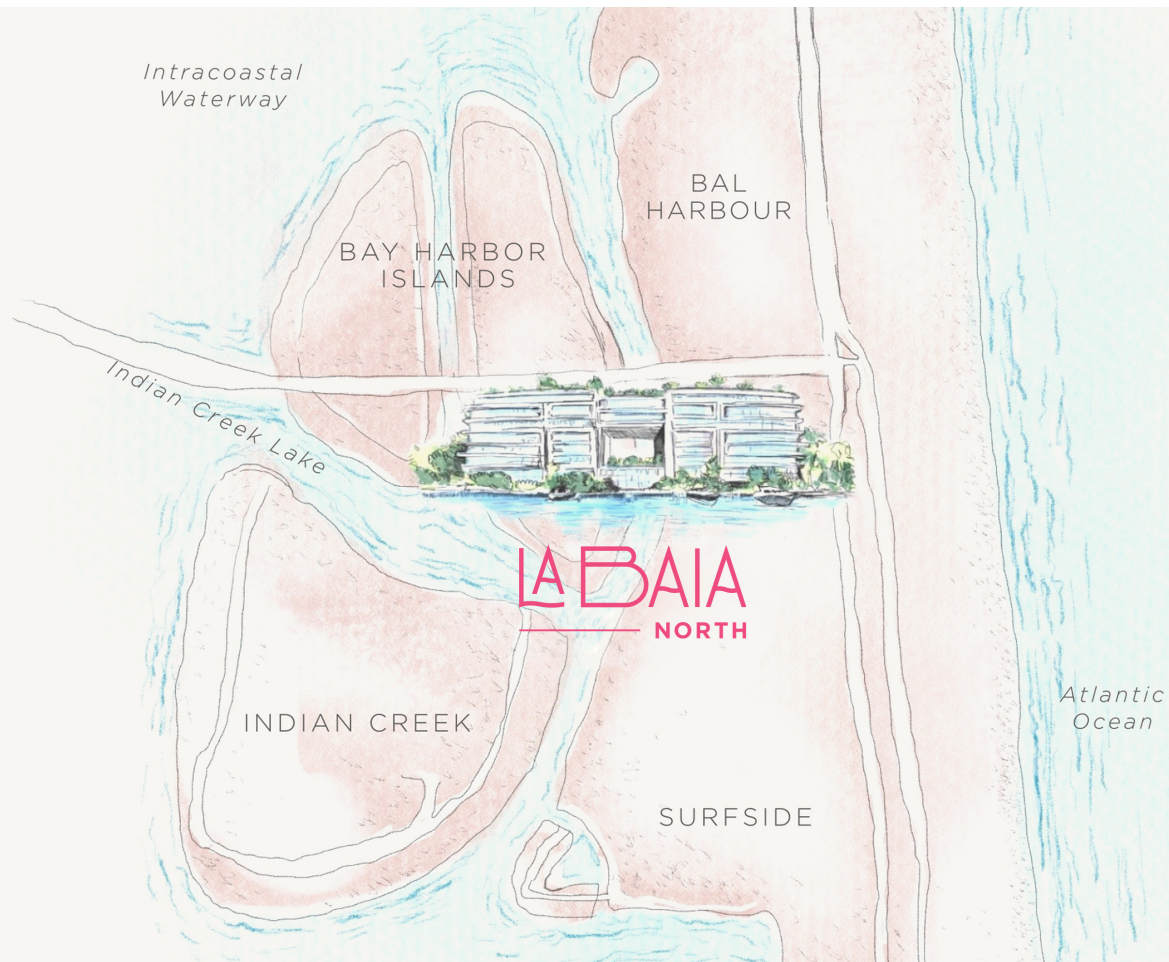

Aventura	<b>6.7 miles</b>	Miami-Country Day School	<b>5.2 miles</b>
Bal Harbour	<b>0.6 mile</b>	Miami Design District	<b>8.4 miles</b>
Brickell Financial District	<b>13.7 miles</b>	Miami International Airport	<b>15.7 miles</b>
Coconut Grove	<b>16.4 miles</b>	Miami-Opa Locka Executive Airport	<b>10 miles</b>
Coral Gables	<b>18.2 miles</b>	Midtown Miami	<b>8.6 miles</b>
Downtown Miami	<b>12.7 miles</b>	Nearest Beach Access	<b>0.6 mile</b>
Fisher Island	<b>11.4 miles</b>	South Beach	<b>8.3 miles</b>
Fort Lauderdale-Hollywood International Airport	<b>17.9 miles</b>	Sunny Isles Beach	<b>4.7 miles</b>
Haulover Beach	<b>2.5 miles</b>	The Cushman School	<b>6.8 miles</b>
Key Biscayne	<b>21.7 miles</b>	Wynwood Art District	<b>9.6 miles</b>
Las Olas, Fort Lauderdale	<b>21.5 miles</b>		

# RESIDENCE TYPES - BAY VIEWS

2-TO-4 BEDROOM RESIDENCES AND PENTHOUSES

## UPPER AND LOWER PENTHOUSES LEVELS 7 - 8

Corner Residence 01 & 09  
4 Bed, 4.5 Bath  
2,076 SF

Residence 03 & 07  
3 Bed, 4 Bath, + Den  
1,811 SF

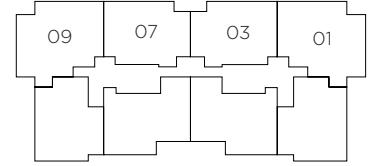

## RESIDENCE LEVELS 4 - 6

Corner Residence 01 & 09  
4 Bed, 4.5 Bath  
2,111 SF

Residence 03 & 07  
3 Bed, 4 Bath, + Den  
1,811 SF

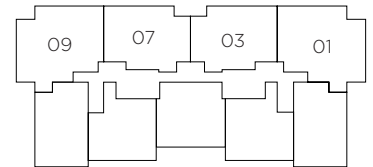

## RESIDENCE LEVELS 2 - 3

Corner Residence 01 & 09  
4 Bed, 4.5 Bath  
2,111 SF  
+ Private staircase for  
Level 2 Residences

Residence 03 & 07  
2 Bed, 3.5 Bath, + Den  
1,533 SF  
+ Private staircase for  
Level 2 Residences

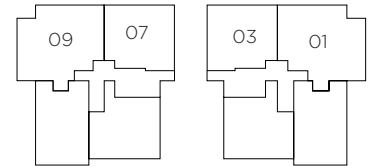

# RESIDENCE TYPES - SUNSET/CITY VIEWS

2-TO-3 BEDROOM RESIDENCES AND PENTHOUSES

## UPPER AND LOWER PENTHOUSE LEVELS 7 - 8

### Corner Residence 02 & 10

3 Bed, 3.5 Bath, + Den

1,834 SF

### Residence 04 & 08

2 Bed, 3 Bath, + Den

1,616 SF

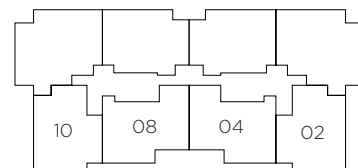

## RESIDENCE LEVELS 4 - 6

### Corner Residence 02 & 10

2 Bed, 2.5 Bath, + Den

1,450 SF

### Residence 06

2 Bed, 3.5 Bath, + Den

1,486 SF

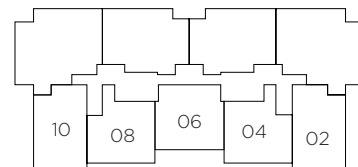

### Residence 04 & 08

2 Bed, 2.5 Bath, + Den

1,432 SF

## RESIDENCE LEVELS 2 - 3

### Corner Residence 02 & 10

2 Bed, 2.5 Bath, + Den

1,450 SF

\*1,000 SF balcony on Level 2

### Residence 04 & 08

2 Bed, 2.5 Bath, + Den

1,432 SF

\*Only available on Level 3

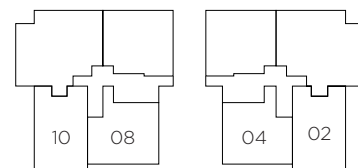



## INQUIRE TODAY

Connect with a La Baia North Sales Executive



305-778-2058

[info@labaiabayharbor.com](mailto:info@labaiabayharbor.com)

[labaiabayharbor.com](http://labaiabayharbor.com)

LA BAIA NORTH

Site Address

9481 East Bay Harbor Drive, Bay Harbor Islands, Florida 33154

Sales Gallery

1111 Kane Concourse, Suite 150, Bay Harbor Islands, Florida 33154

ORAL REPRESENTATIONS CANNOT BE RELIED UPON AS CORRECTLY STATING THE REPRESENTATIONS OF THE DEVELOPER. FOR CORRECT REPRESENTATIONS, MAKE REFERENCE TO THIS BROCHURE AND TO THE DOCUMENTS REQUIRED BY SECTION 718.503, FLORIDA STATUTES, TO BE FURNISHED BY A DEVELOPER TO A BUYER OR LESSEE

Ian Bruce Eichner ("IBE") is not the project Developer. This Condominium is being developed by Bay Harbor Islands Property Owner II LLC, a Delaware limited liability company ("Developer"). Any and all statements, disclosures and/or representations shall be deemed made by Developer and not by IBE and any purchaser agrees to look solely to Developer (and not to IBE and/or any of his affiliates) with respect to any and all matters relating to the marketing and/or development of the Condominium and with respect to the sales of units in the Condominium. This is not intended to be an offer to sell, or solicitation to buy, condominium units to residents of any jurisdiction where prohibited by law, and your eligibility for purchase will depend upon your state of residency. This offering is made only by the prospectus for the condominium and no statement should be relied upon if not made in the prospectus. All features, specifications, brands, matters of detail are conceptual only and should not be relied upon as representations, express or implied, of the final detail of the residences or condominium. The Developer expressly reserves the right to make modifications, revisions, omissions and changes without notice. Certain features may not be included with all units. Square footages, ceiling heights are all subject to change. Developer makes no representations regarding views from any particular unit. Your purchase agreement will detail items included with the Unit.

